

Southern Spiral Pipe, Inc.

Single Wall Round

Construction Standards for Single Wall Round Spiral Pipe and Fittings

Galvanized Steel (ASTM A 527), Paintgrip, and Stainless Steel

Max. Dia.	+2" w.g.		+10" w.g.	
	Pipe Ga.	Fitting Ga.	Pipe Ga.	Fitting Ga.
3"-6"	28	28	28	28
7"-8"	28	28	28	26
9"-10"	28	26	28	26
11"-12"	28	26	26	24
13"-14"	28	26	26	24
15"-16"	26	24	24	22
17"-18"	26	24	24	22
19"-26"	26	24	24	22
27"-36"	24	22	22	20
37"-50"	22	20	20	20
51"-60"	20	18	18	18
61"-84"	18	16	18	16

Aluminum

Dia.	+2" w.g.		-2" w.g.	
	Pipe Ga.	Fitting Ga.	Pipe Ga.	Fitting Ga.
3" thru 8"	.025"	.032"	.025"	.040"
9" thru 14"	.025"	.032"	.032"	.040"
15" thru 26"	.032"	.040"	.040"	.050"
27" thru 36"	.040"	.050"	.050"	.063"
37" thru 50"	.050"	.063"	.063"	.071"
51" thru 60"	.063"	.071"	N.A.	.090"
61" thru 84"	N.A.	.090"	N.A.	N.A.

Gauges shown above are per 1995 SMACNA Construction Standards.
Gauges shown are minimum gauges and in some cases may be heavier.

Contact factory for construction standards for other pressure classes.

Southern Spiral Pipe, Inc.

Single Wall Round

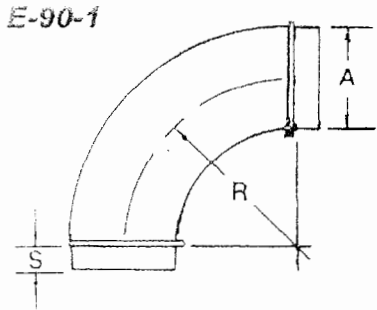

Sizes 3"-12"

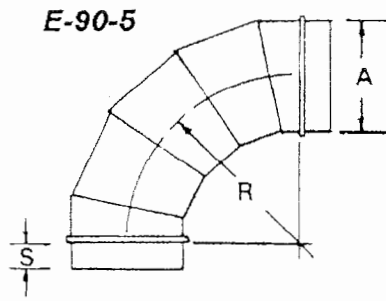

M-90-V

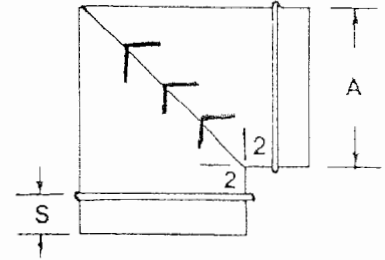

E-45-1

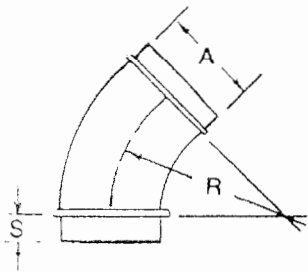

Sizes 3" - 12"

E-45-3

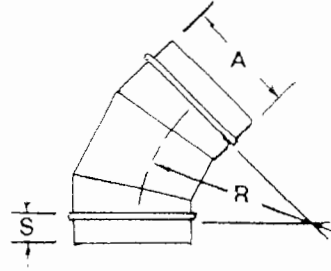

HT-90

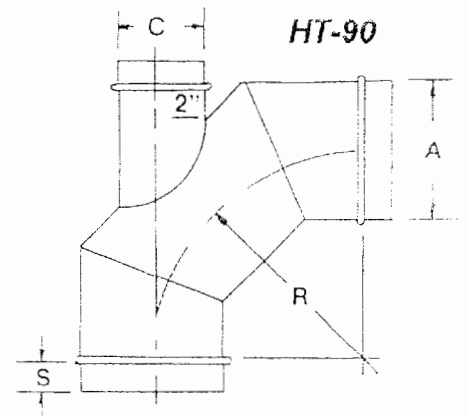

E-60-3

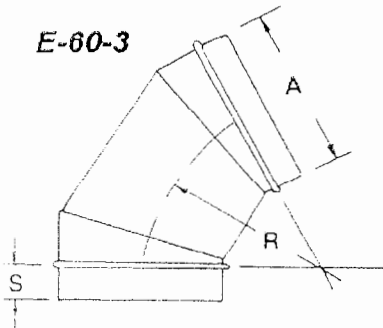

E-30-2

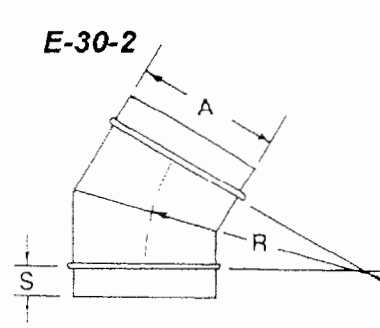

$R = 1.5 \text{ times } A$ (Standard - Other options available)
 $S = 2"$

For example: E-90-5

- "E" denotes "Elbow"
- "90" denotes "Angle"
- "5" denotes "number of gores"

□ Model numbers above denote standards.

* Unlimited variations*

Southern Spiral Pipe, Inc.

Single Wall Round

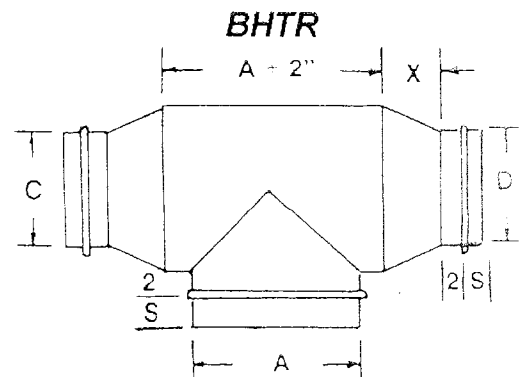
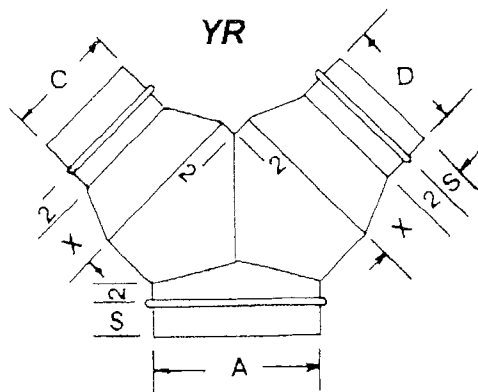
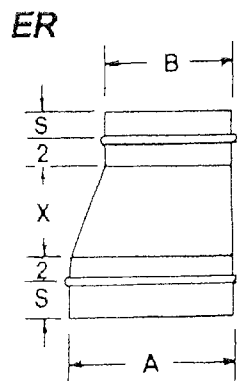
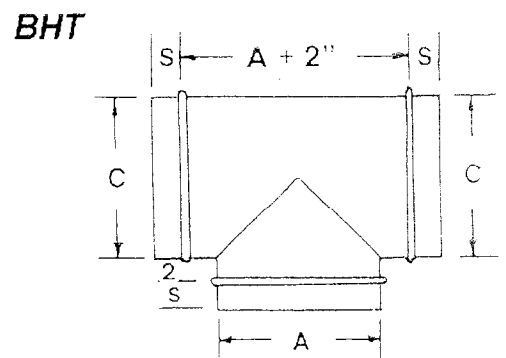
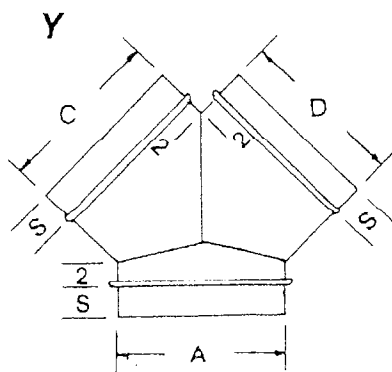
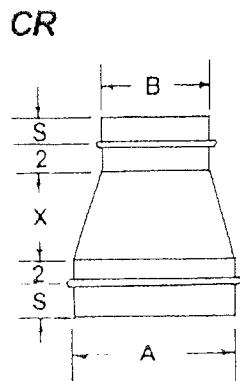
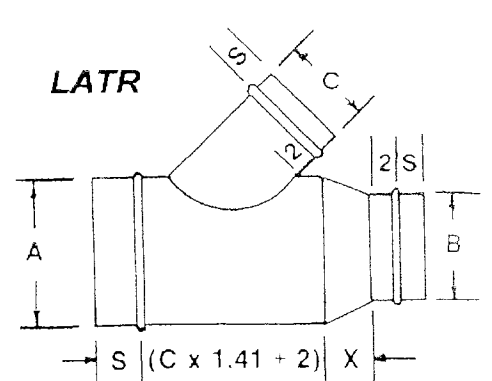
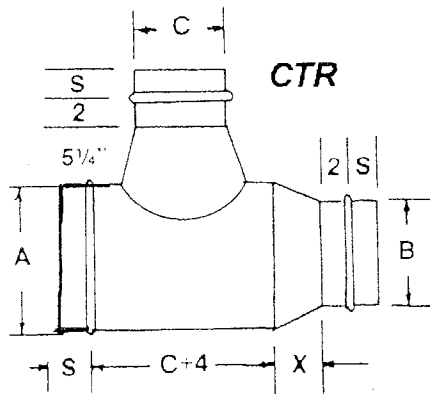
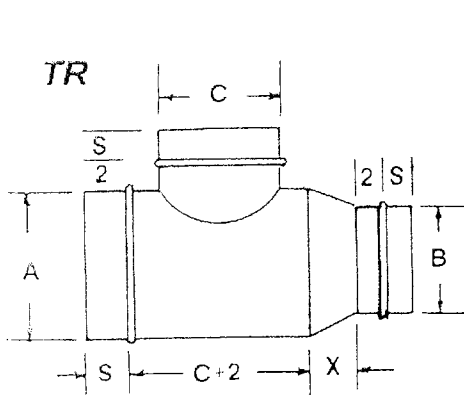
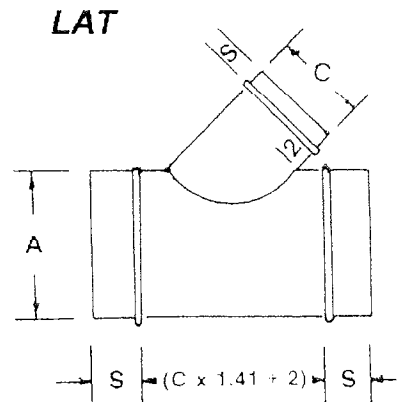
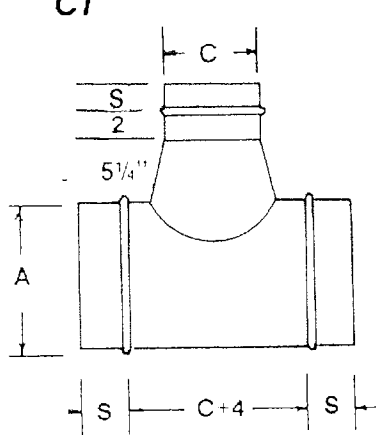
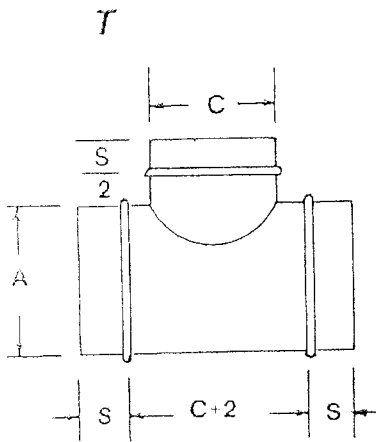

Southern Spiral Pipe, Inc.

Single Wall Round

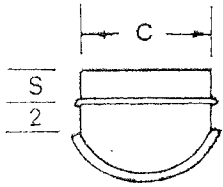

90 SAD

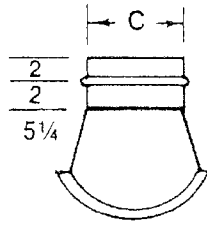

90 CSAD

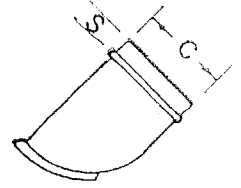

45 SAD

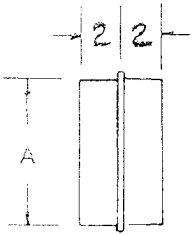

PIPE
COUPLING

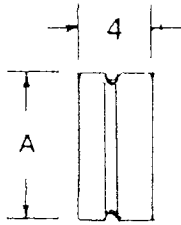

FITTING
COUPLING

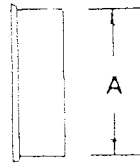

END CAP

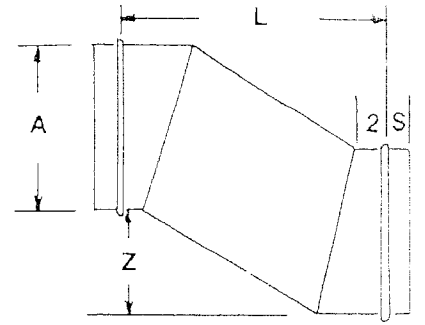

OFFSET

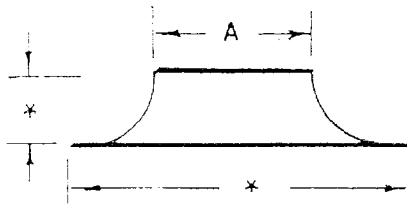

BELLMOUTH
*Consult Factory